

BOARD TO BOARD FEMALE 0.8mm RIGHT ANGLE TYPE

SPECIFICATION

Current Rate:0.5 AMP
 Insulation Resistance:100MΩ Min
 Contact Resistance:20mΩ Max
 Dielectric voltage:500V AC for one minute
 Operation Temperature:-40°C to + 105°C

MATERIAL

Insulator:Polyester,UL 94V-0
 ◎Standard:Nylon 46
 Contact Pin:Phosphor Bronze
 Contact Plated:Gold Plated

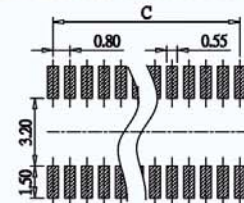
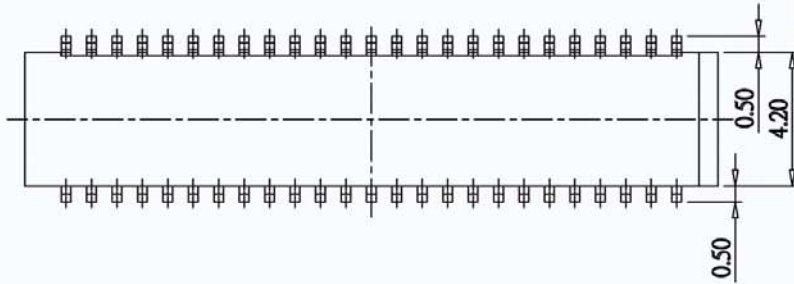
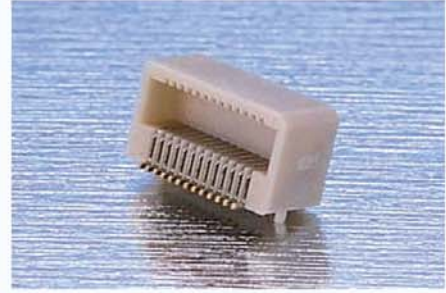

Recommended PCB Layout
 (PCB TOLERANCE ±0.05)

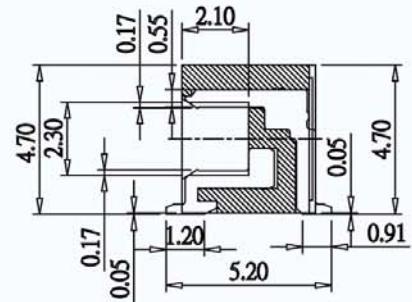
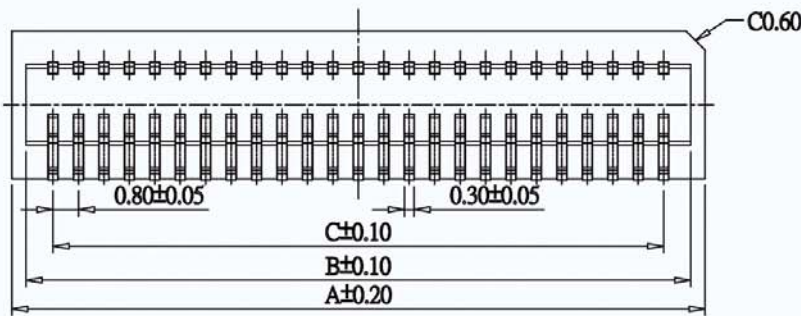

CIRCUITS	DIMENSION			CIRCUITS	DIMENSION		
	A	B	C		A	B	C
10	5.80	4.90	3.20	32	14.60	13.70	12.00
12	6.60	5.70	4.00	34	15.40	14.50	12.80
14	7.40	6.50	4.80	36	16.20	15.30	13.60
16	8.20	7.30	5.60	38	17.00	16.10	14.40
18	9.00	8.10	6.40	40	17.80	16.90	15.20
20	9.80	8.90	7.20	50	21.80	20.90	19.20
22	10.60	9.70	8.00	60	25.80	24.90	23.20
24	11.40	10.50	8.80	68	29.00	28.10	26.40
26	12.20	11.30	9.60	70	29.80	28.90	27.20
28	13.00	12.10	10.40	80	33.80	32.90	31.20
30	13.80	12.90	11.20	90	37.80	36.90	35.20
				100	41.80	40.90	39.20

◎After Mating Height

MALE	FEMALE	BTB08FBR-XX
BTB08MC-XX		5.65
BTB08MC40-XX		6.15

ORDER INFORMATION

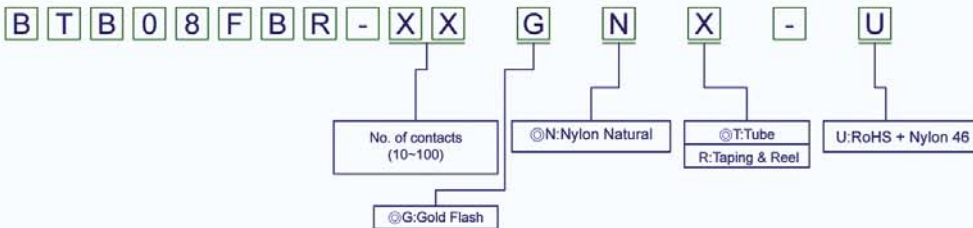

◎:Standard Recommend